

LAV FAUCET INSTALLATION



Model #:
AG202-1
AG204-1

BEFORE YOU BEGIN YOUR INSTALLATION:

1

Turn off water supply.

2

Observe all local plumbing codes.

3

Inspect plumbing for signs of damage. Replace as necessary.

4

DO NOT use petroleum based products on this faucet.

REQUIRED TOOLS AND MATERIALS:

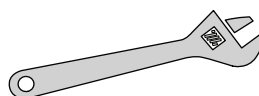

ADJUSTABLE WRENCH

WARNING: Cancer and reproductive harm - see www.P65Warnings.ca.gov

IMPORTANT!

- Read these instructions and plan the installation before beginning.
- Risk of product damage. Do not apply direct heat to the valve. Excessive heat will damage the plastic components and plaster guard.
- A mixed water supply is required for this product.
- Component location, spacing, and situational requirements can vary.

1.

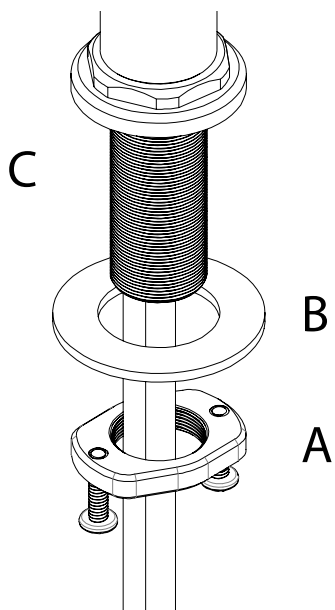

Remove the clamp nut (A) and washer (B) from the threaded shroud (C).

2.

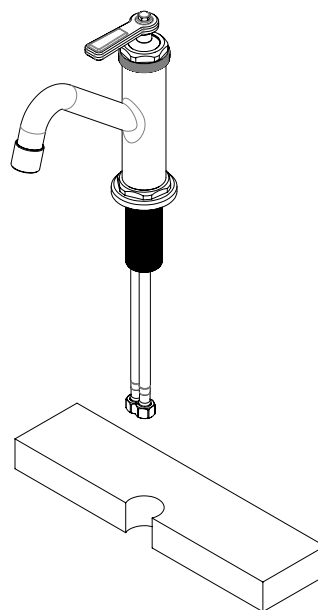

Fit flexible hoses (D) through hole on counter or sink. (No plumbers putty is required. O-ring seals base).

3.

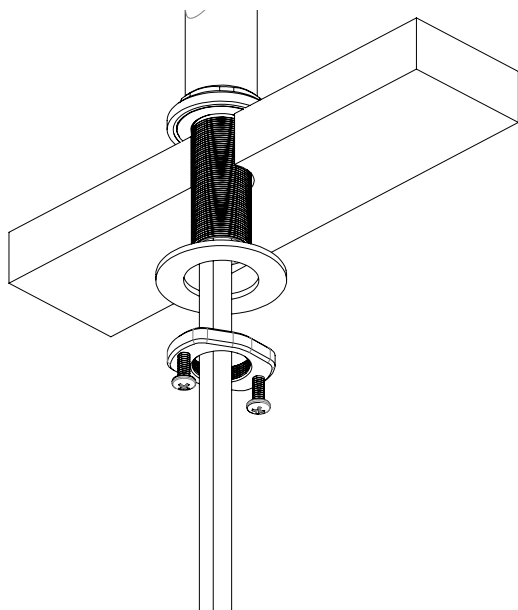

Slide washer and thread the clamp nut onto threaded shroud. Tighten nut snug to underside of sink or counter.

4.

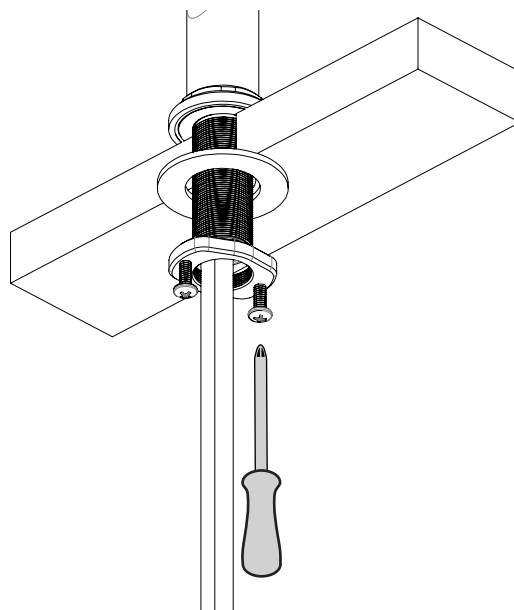

Turn faucet to the desired handle position. Securely tighten clamp screws (E).



41180 Raintree Court
Murrieta, CA 92562
1-888-304-0660 • 951-304-0520
www.waterstoneco.com