

ARGONAUT

by  WATERSTONE
FAUCETS

Diverter Trim Model: AG231-1



The Argonaut collection from Waterstone is a new line of bath and shower faucets designed and manufactured in Southern California. Waterstone is world-renowned for its unique and distinctive kitchen faucets.

We have now adapted the same creativity and craftsmanship to fixtures for the bath. Inspired by our Nautical roots, Argonaut sets out to inspire and exact an emotional feeling with our customers. Waterstone's craftsmanship and durability are guaranteed through our lifetime warranty.

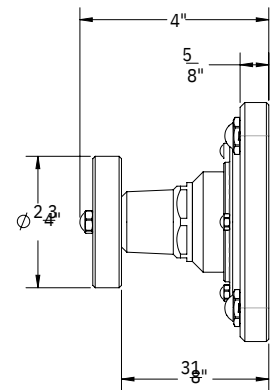
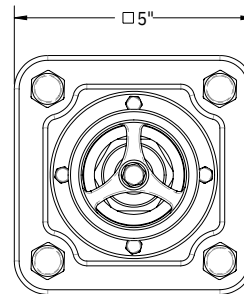
- Rough-in 10121 required (sold separately).
- Single handle diverter allows a quick switch between 2 or 3 individual components.
- When turned, the handle gently clicks into the desired function.
- Includes cartridge stem extension kit for wall thickness up to 3"
- Available in 6 designer finishes: CD, CH, MB, PN, SN, UPB & split finish.
- Diamond cut knurling accents.
- Machined from solid brass in Murrieta, CA.



Tag Us on Social Media

-  [facebook.com/waterstonefaucets](https://www.facebook.com/waterstonefaucets)
-  [@waterstone_faucets](https://www.instagram.com/waterstone_faucets)
-  [linkedin.com/company/waterstone-faucets-official](https://www.linkedin.com/company/waterstone-faucets-official)



waterstoneco.com



Rough-in 10121 required
sold separately

Split Finishes

Faucet can be split using any combination of the standard finishes listed below. For pricing add 10% to the higher list price of the 2 finishes.

Group 1

- Chrome - CH

Group 2

- Chardonnay - CD
- Matte Black - MB
- Polished Nickel - PN
- Satin Nickel - SN
- Unlacquered Polished Brass - UPB

HOW TO DESIGNATE A SPLIT FINISH FAUCET WHEN ORDERING

Take the model number and add both finishes to the suffix starting with the Primary finish followed by the Accent finish. For Matte Black (MB) and Chardonnay (CD), it would be AG254-1-MB_CD. If you wanted Chardonnay (CD) and Polished Nickel (PN) it would be AG254-1-CD_PN. For all split finish designs click "Split Finishes" in the top menu of our home page on www.waterstoneco.com

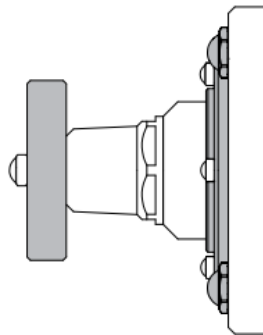
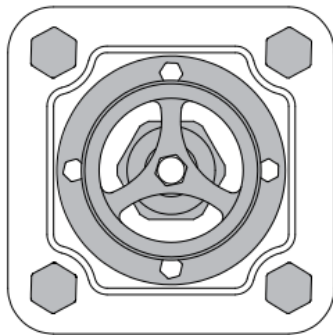

White = Primary finish
Gray = Accent finish

AG231-1

