

REQUIRED TOOLS:

1-1/8" Deepwell Socket

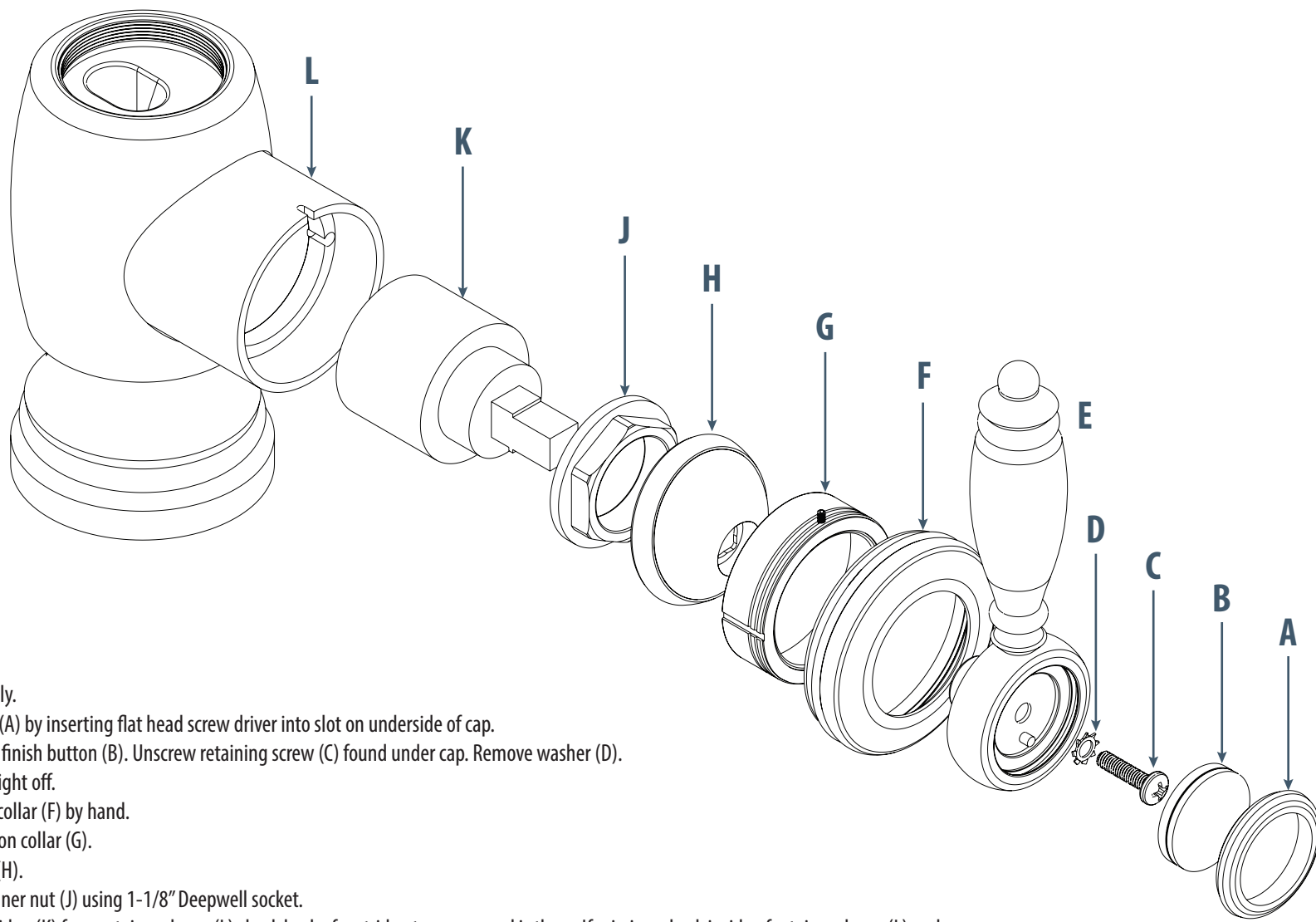

Phillips & Flat Screwdriver

**INSTALLATION GUIDE - TRADITIONAL 35MM CARTRIDGE****MODEL #**4100-12/18, 4200, 4300, 4400, 4410-12/18
4700, 4800, 4900, 5100, 5200, 5210
5500, 5600, 561041180 Raintree Court • Murrieta, CA 92562
1-888-304-0660 • 951-304-0520
www.waterstoneco.com

1. Turn off water supply.
2. Pop off handle cap (A) by inserting flat head screw driver into slot on underside of cap.
3. Remove ceramic or finish button (B). Unscrew retaining screw (C) found under cap. Remove washer (D).
4. Pull handle (E) straight off.
5. Unscrew retaining collar (F) by hand.
6. Remove brass friction collar (G).
7. Remove valve ball (H).
8. Unscrew valve retainer nut (J) using 1-1/8" Deepwell socket.
9. Remove valve cartridge (K) from retainer sleeve (L) check back of cartridge to ensure seal is there. If missing, check inside of retainer sleeve (L) and remove.
10. Install new valve cartridge by hand and tighten retaining nut (J) by hand. Turn water on to faucet and check for leaks if present tighten nut until leak is no longer present.
11. Reassemble remaining parts in reverse order. DO NOT over tighten retaining collar (F) hand tighten only then after installing handle continue to tighten by hand until handle is set to preferred tension.