

REQUIRED TOOLS:



1. Phillips Screwdriver
2. Adjustable Wrench



INSTALLATION GUIDE - MODERN / INDUSTRIAL 25MM CARTRIDGE

MODEL

9300, 9350, 9400, 9410, 9450, 9460, 9700, 9750, 9800, 9810, 9850, 9860, 9900, 9910, 9930, 9940, 9950, 9960, 9980, 9990, 10200, 10210, 10220, 10230, 10240, 10250, 10260, 10270, 10280, 10290, 10300, 10310, 10320, 10330, 10340, 10350, 10360, 10370, 10380, 10390

41180 Raintree Court • Murrieta, CA 92562
1-888-304-0660 • 951-304-0520
www.waterstoneco.com

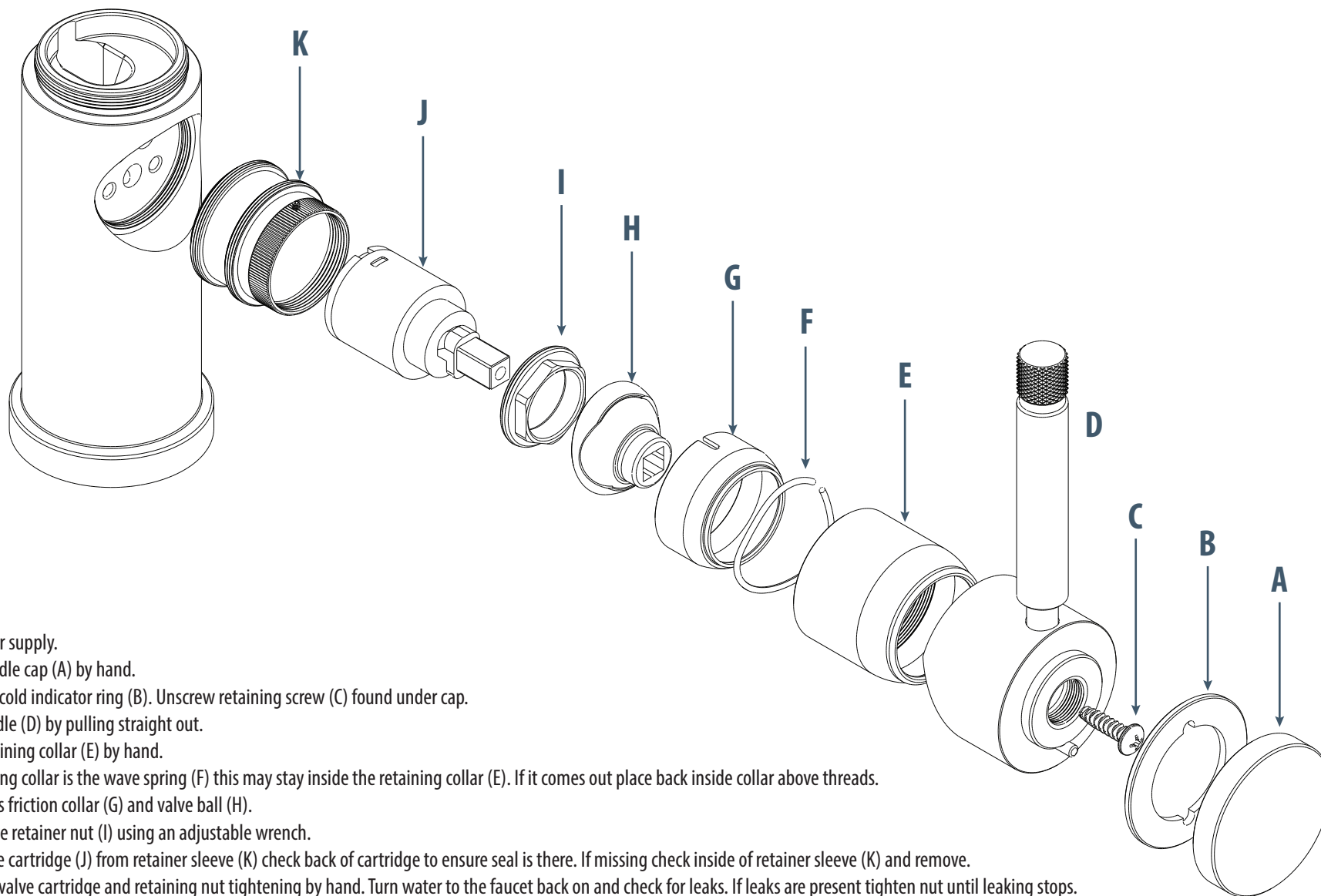

1. Turn off water supply.
2. Unscrew handle cap (A) by hand.
3. Remove hot/cold indicator ring (B). Unscrew retaining screw (C) found under cap.
4. Remove handle (D) by pulling straight out.
5. Unscrew retaining collar (E) by hand.
6. Inside retaining collar is the wave spring (F) this may stay inside the retaining collar (E). If it comes out place back inside collar above threads.
7. Remove brass friction collar (G) and valve ball (H).
8. Unscrew valve retainer nut (I) using an adjustable wrench.
9. Remove valve cartridge (J) from retainer sleeve (K) check back of cartridge to ensure seal is there. If missing check inside of retainer sleeve (K) and remove.
10. Install new valve cartridge and retaining nut tightening by hand. Turn water to the faucet back on and check for leaks. If leaks are present tighten nut until leaking stops.
11. Reassemble remaining parts in reverse order. DO NOT over tighten retaining collar (E) hand tighten only then after installing handle continue to tighten by hand until handle is set to preferred tension.